

N Male Crimp Connector For RG316 Cable

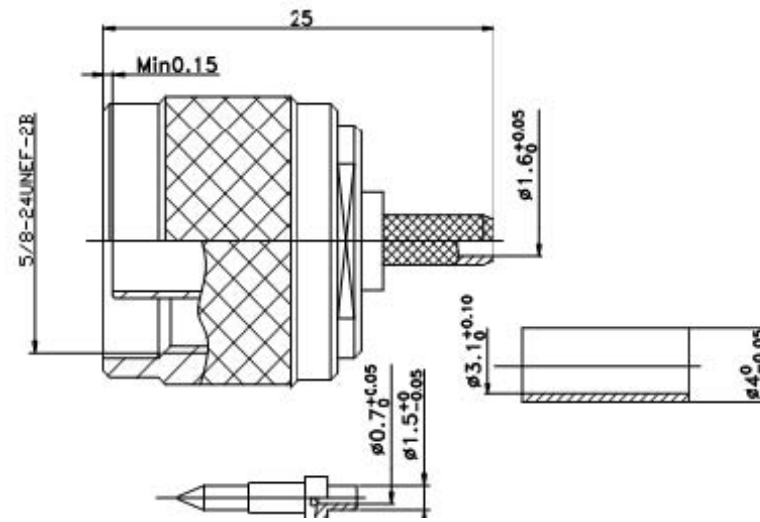

Interface
According to IEC 60169-16

Electrical Characteristic
Impedance 50 ohm
Frequency Range DC-11GHz
VSWR ≤ 1.20 @DC-3000MHz
Dielectric Withstanding
Voltage $\geq 2500V$ RMS, 50Hz, at sea level Dielectric
Resistance $\geq 5000M\Omega$ Contact
Resistance Center Contact $\leq 1.0m\Omega$
Outer Contact $\leq 0.25m\Omega$

Mechanical			
Durability		Mating cycles	≥ 500
Material and plating			
Body	Material	Plating	
Insulator	Brass	Ni	
Center conductor	PTFE	—	
Coupling Nut	Phosphor bronze	Au	
Other Parts	Brass	Ni	
Crimping Ferrule	Brass	Ni	
Environmental	Annealed copper	Ni	
Temperature Range			$-40^{\circ}C \sim +85^{\circ}C$
Weatherproof Rate			IP 68
RoHs Compliant			